



Property Highlights

- +/- 1,985 SF retail opportunity in a newer, modern center built in 2022
- Excellent visibility with prominent storefront and strong surrounding commercial activity
- Shell condition space allows tenants to design a layout that fits their brand and operations
- Large storefront windows provide natural light and strong signage presence
- Individually controlled rooftop HVAC; tenant-controlled comfort and efficiency
- Ample shared surface parking with easy access for customers and employees

High Visibility Retail Suite

4751 Progress Dr. Davenport, IA
 Suite 200

FOR LEASE	\$25.00 _{PSF NNN}
SUITE SIZE	1,985 SF

Details

Parcel	N0853C01
Zoning	C-2
Year Built	2022
Building Size	7,495 SF
Operating Expenses	\$8.00 PSF



SHAWN LANGAN
Vice President/Director
o: 563-823-5113
c: 563-343-6597
e: slangan@ruhlcommercial.com



PETE HADJIS
Sales Manager/Vice President
o: 563-355-4000
c: 319-640-0527
e: phadjis@ruhlcommercial.com



CARRIE LAMB
Commercial Sales Associate
o: 563-355-4000
c: 815-716-0264
e: clamb@ruhlcommercial.com

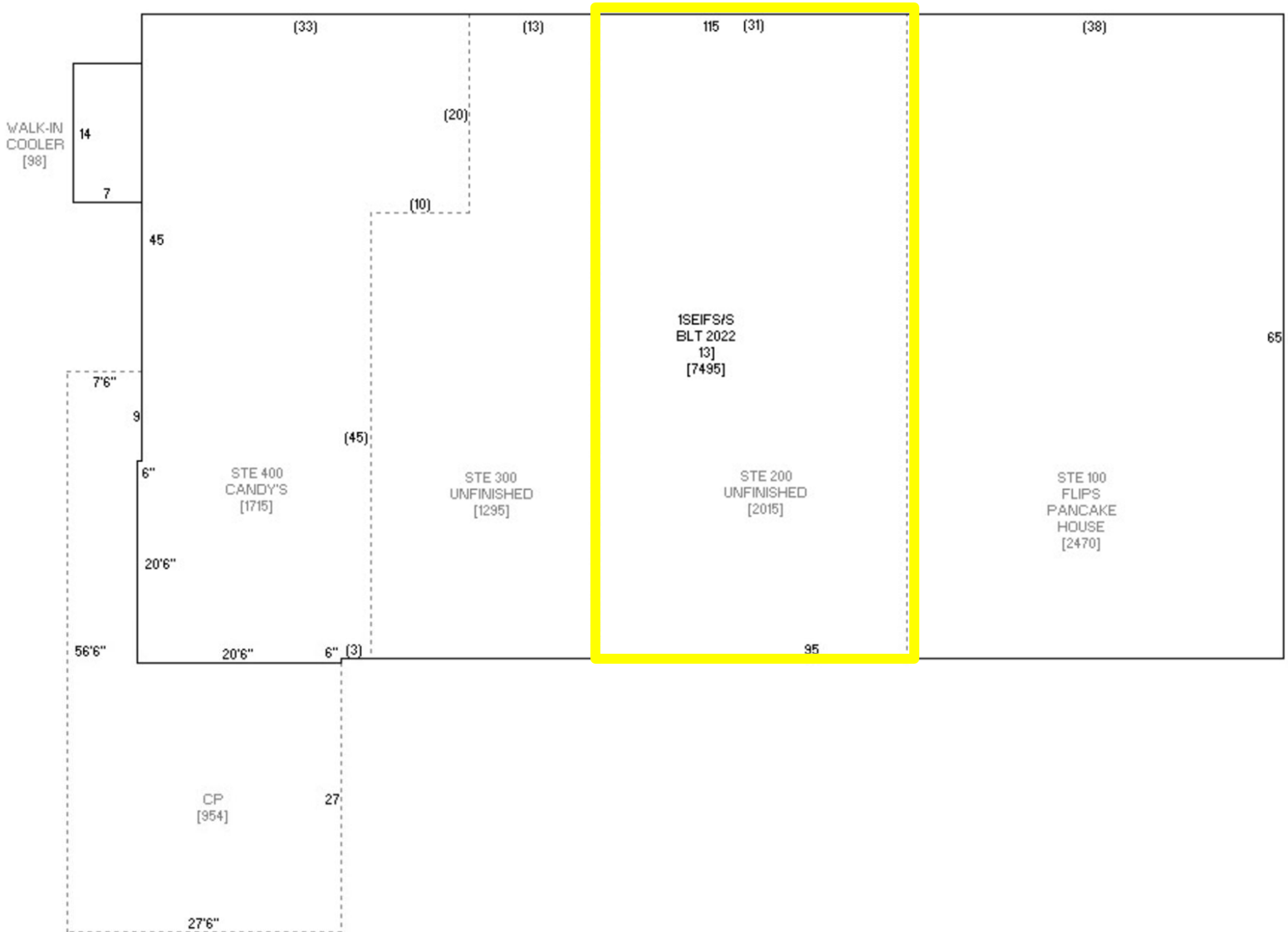

Sketch by www.camavision.com



SHAWN LANGAN
 Vice President/Director
 o: 563-823-5113
 c: 563-343-6597
 e: slangan@ruhlcommercial.com



PETE HADJIS
 Sales Manager/Vice President
 o: 563-355-4000
 c: 319-640-0527
 e: phadjis@ruhlcommercial.com



CARRIE LAMB
 Commercial Sales Associate
 o: 563-355-4000
 c: 815-716-0264
 e: clamb@ruhlcommercial.com