



**LH** 2902 Indian Road  
 Davenport, Iowa 52802



**Property Features:**

- **Spacious Warehouse:** Approximately 11,072 SF providing ample room for operations
- **Well-Equipped Office Space:** Approximately 918 SF of office space, including a reception area, kitchenette, and bathroom with shower
- **Enhanced Features:** Warehouse features forced air and radiant heat, three-phase electric power, and impressive 17-foot ceilings
- **Convenient Access:** Two overhead doors (16X20 and 10x10) with concrete dock for easy loading/unloading
- **Comfortable Environment:** Office space has heat, AC and a professional atmosphere
- **Secure and Organized:** Fenced-in lot and outdoor storage area on 1.22-acre property
- **Ample Parking and Loading Space:** Take advantage of the large lot for convenient parking and smooth logistical operations

**DETAILS:**

AVAILABLE SF:	11,990 SF (11,072 SF WAREHOUSE) (918 SF OFFICE)
PRICE PER SQUARE FOOT:	\$5.50 NNN
TOTAL OPERATING EXPENSES:	\$3.50 PSF
TAXES:	\$11,680 (2022)
PARCEL:	J0030-17C
ZONING:	I-1
PARKING:	FENCED-IN LOT
LOCATION:	CORNER LOT

NO WARRANTY OR REPRESENTATION, EXPRESS OR IMPLIED, IS MADE AS TO THE ACCURACY OF THE INFORMATION CONTAINED HEREIN, AND THE SAME IS SUBMITTED SUBJECT TO ERRORS, OMISSIONS, CHANGE OF PRICE, RENTAL OR OTHER CONDITIONS, PRIOR SALE, LEASE OR FINANCING, OR WITHDRAWAL WITHOUT NOTICE, AND OF ANY SPECIAL LISTING CONDITIONS IMPOSED BY OUR PRINCIPALS NO WARRANTIES OR REPRESENTATIONS ARE MADE AS TO THE CONDITION OF THE PROPERTY OR ANY HAZARDS CONTAINED THEREIN ARE ANY TO BE IMPLIED.

UPDATED: 8/01/22

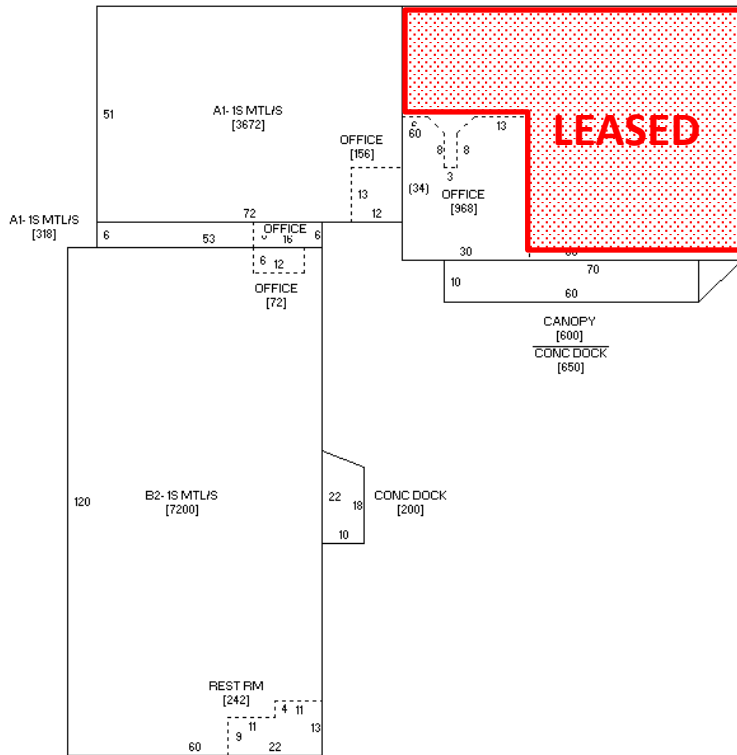

**SHAWN LANGAN**  
 Vice President/Director  
 DIRECT: 563.823.5113  
 CALL OR TEXT: 563.343.6597  
 EMAIL: [slangan@ruhlcommercial.com](mailto:slangan@ruhlcommercial.com)



**PETE HADJIS**  
 Vice President  
 OFFICE: 563.355.4000  
 CALL OR TEXT: 319.640.0527  
 EMAIL: [phadjis@ruhlcommercial.com](mailto:phadjis@ruhlcommercial.com)

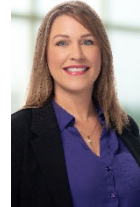

**CARRIE LAMB**  
 Commercial Sales Associate  
 OFFICE: 563.355.4000  
 CALL OR TEXT: 815.716.0264  
 EMAIL: [clamb@ruhlcommercial.com](mailto:clamb@ruhlcommercial.com)