



1601 River Drive
Moline, Illinois 61265



Property Features

- Former chop house located on the first floor of Riverstation
- Centered in the heart of the Moline business district
- Space features high end finishes, private rooms, outdoor patio area, large dining room, kitchen space, and walk in cooler & freezer
- Ample parking across the street and east side of building
- Outdoor patio neighbors with the Bass Street Landing which features outdoor events including the Friday night concert series
- Within walking distance to the Vibrant Arena (multipurpose area) conference center, and multiple hotel chains
- Based on former layout maximum capacity of 198
- *Price Per SF subject to terms

Details	
Available SF:	6,676* SF with Subdivision available
Price PSF:	\$9.95 PSF
Total Operating Expenses:	\$12.29 PSF
Location:	Downtown Moline
Parking:	Ample
Signage:	Building & Monument
Best/Practical Use:	Restaurant/Reception venue, Class A office, High profile retail

NO WARRANTY OR REPRESENTATION, EXPRESS OR IMPLIED, IS MADE AS TO THE ACCURACY OF THE INFORMATION CONTAINED HEREIN, AND THE SAME IS SUBMITTED SUBJECT TO ERRORS, OMISSIONS, CHANGE OF PRICE, RENTAL OR OTHER CONDITIONS, PRIOR SALE, LEASE OR FINANCING, OR WITHDRAWAL WITHOUT NOTICE, AND OF ANY SPECIAL LISTING CONDITIONS IMPOSED BY OUR PRINCIPALS NO WARRANTIES OR REPRESENTATIONS ARE MADE AS TO THE CONDITION OF THE PROPERTY OR ANY HAZARDS CONTAINED THEREIN ARE ANY TO BE IMPLIED.

UPDATED: #####



Current Floor Plan

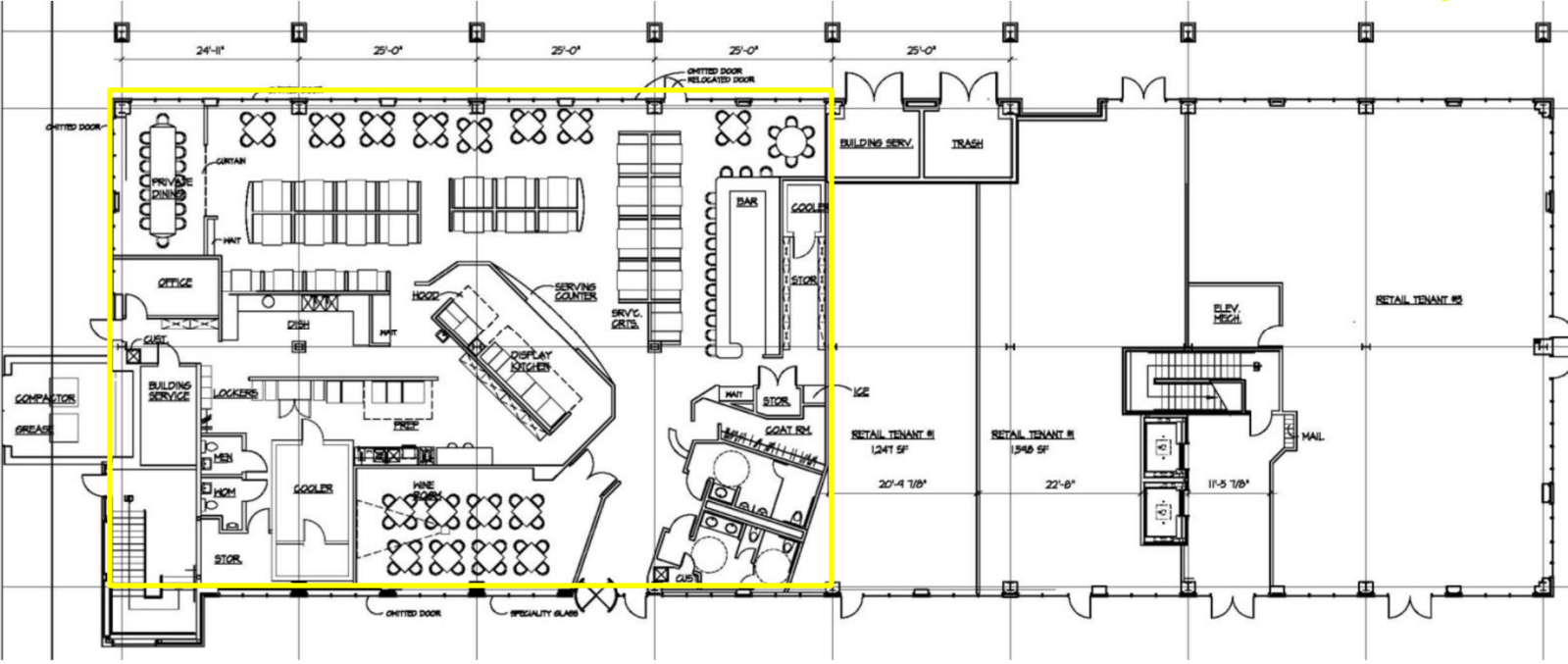

Proposed Sub-Divided Floor Plan





BASS STREET LANDING



John G. Ruhl
*CEO/Designated
Managing Broker*
call or text: 563.320.5488
email: jruhl@ruhlcommercial.com



Shawn Langan
Vice President/Director
call or text: 563.343.6597
email: slangan@ruhlcommercial.com



Richard J. Schaefer
Vice President/Director
direct: 563.823.5127
call or text: 563.210.4488
email: rschaefer@ruhlcommercial.com



Pete Hadjis
Vice President
office: 563.355.4000
call or text: 319.640.0527
email: phadjis@ruhlcommercial.com