



**1225 E. RIVER DRIVE SUITE DAVENPORT, IA 52803**  
**SUITE 325**

**PROPERTY FEATURES**

- One-of-a-kind Office Space Located at One River Place
- Well Insulated Office Spaces Feature Wood Floors, Brick Walls, and Exposed High Ceilings
- Large Windows throughout provide natural light and beautiful views
- All Utilities, including: Gas, Water, Trash, Electric, and Snow Removal are included with rent
- Building is ADA Accessible with Elevators
- Multiple Common Restrooms and Kitchenette
- Ample On-site Parking and One River Place Signage
- Continued Improvements to One River Place include New Awnings, Flat Panel LED Lights, Paint, and More
- One River Place is situated between Downtown Davenport and the Village of East Davenport on the Mississippi and features incredible views



DETAILS	
AVAILABLE SF:	936 SF
PRICE:	\$2,000/MONTH GROSS
PARKING:	LARGE LOT
BEST USE:	OFFICE
LOCATION:	ONE RIVER PLACE

**GROSS LEASE INCLUDES: GAS, WATER, TRASH, ELECTRIC, AND SNOW REMOVAL. HIGH SPEED FIBER OPTIC INTERNET AVAILABLE FOR AN ADD ON OF \$75/MONTH**

NO WARRANTY OR REPRESENTATION, EXPRESS OR IMPLIED, IS MADE AS TO THE ACCURACY OF THE INFORMATION CONTAINED HEREIN, AND THE SAME IS SUBMITTED SUBJECT TO ERRORS, OMISSIONS, CHANGE OF PRICE, RENTAL OR OTHER CONDITIONS, PRIOR SALE, LEASE OR FINANCING, OR WITHDRAWAL WITHOUT NOTICE, AND OF ANY SPECIAL LISTING CONDITIONS IMPOSED BY OUR PRINCIPALS NO WARRANTIES OR REPRESENTATIONS ARE MADE AS TO THE CONDITION OF THE PROPERTY OR ANY HAZARDS CONTAINED THEREIN ARE ANY TO BE IMPLIED.

UPDATED: 8/01/22

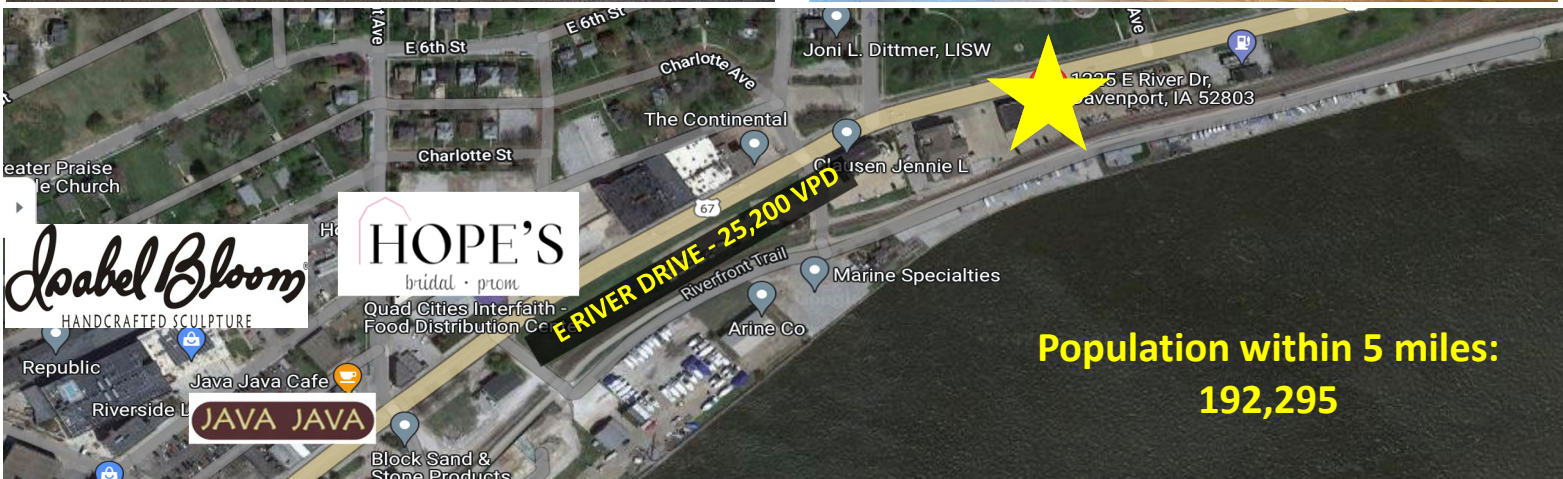
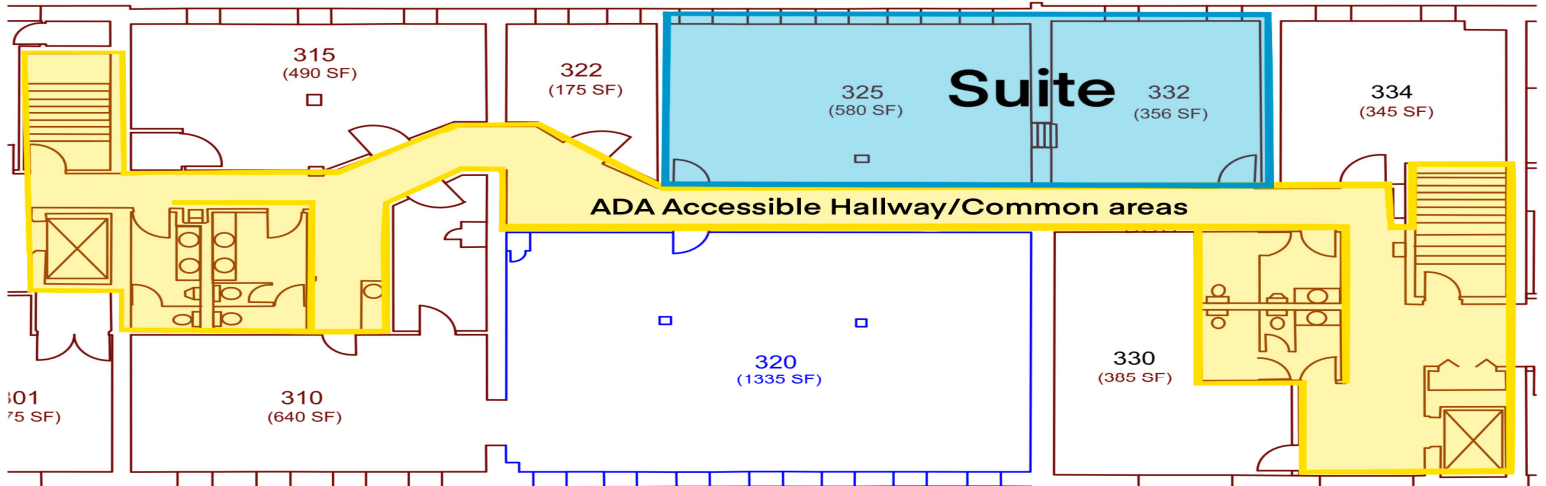

**SHAWN LANGAN**  
Vice President/Director  
DIRECT: 563.823.5113  
CALL OR TEXT: 563.343.6597  
EMAIL: [slangan@ruhlcommercial.com](mailto:slangan@ruhlcommercial.com)



**PETE HADJIS**  
Sales Manager/Vice President  
OFFICE: 563.355.4000  
CALL OR TEXT: 319.640.0527  
EMAIL: [phadjis@ruhlcommercial.com](mailto:phadjis@ruhlcommercial.com)



**SHAWN LANGAN**

*Vice President/Director*

DIRECT: 563.823.5113

CALL OR TEXT: 563.343.6597

EMAIL: [slangan@ruhlcommercial.com](mailto:slangan@ruhlcommercial.com)



**PETE HADJIS**

*Sales Manager/Vice President*

OFFICE: 563.355.4000

CALL OR TEXT: 319.640.0527

EMAIL: [phadjis@ruhlcommercial.com](mailto:phadjis@ruhlcommercial.com)